

NOTES: UNLESS OTHERWISE SPECIFIED

1. APPLICABLE STANDARDS AND SPECIFICATIONS;  
ANSI Y14.5M, DIMENSIONS AND TOLERANCES  
ANSI Y1.1, ABBREVIATIONS
2. WEIGHT CAPACITY: 600 LBS.

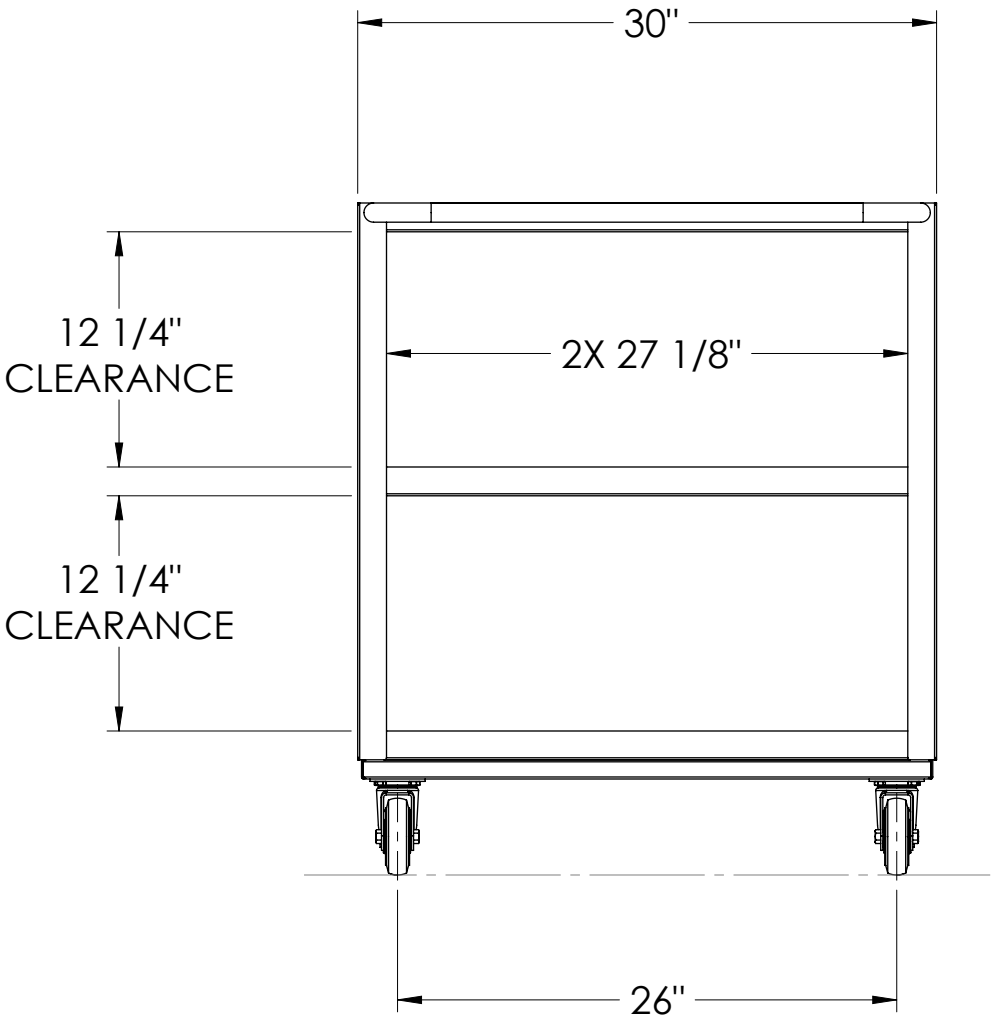
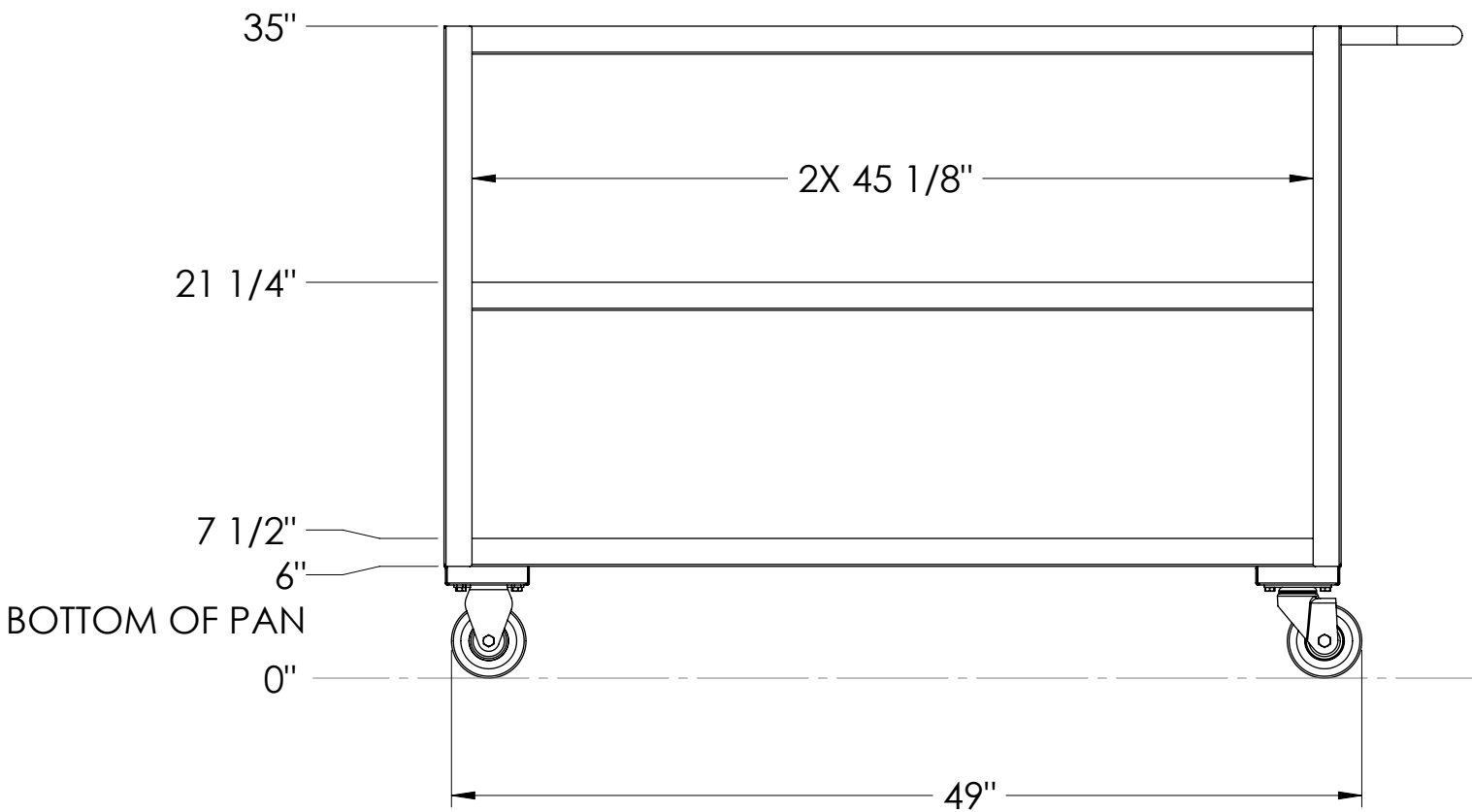
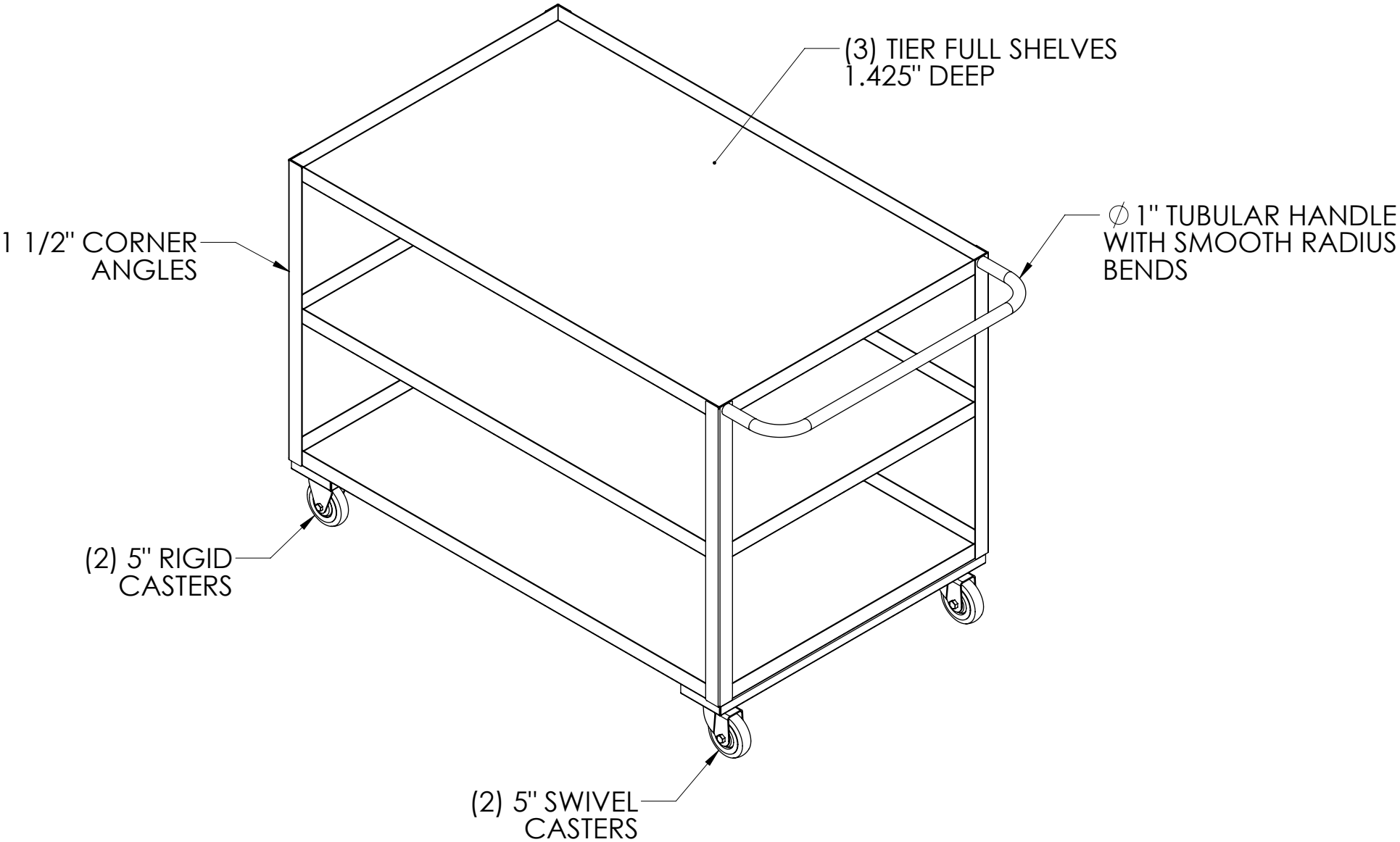
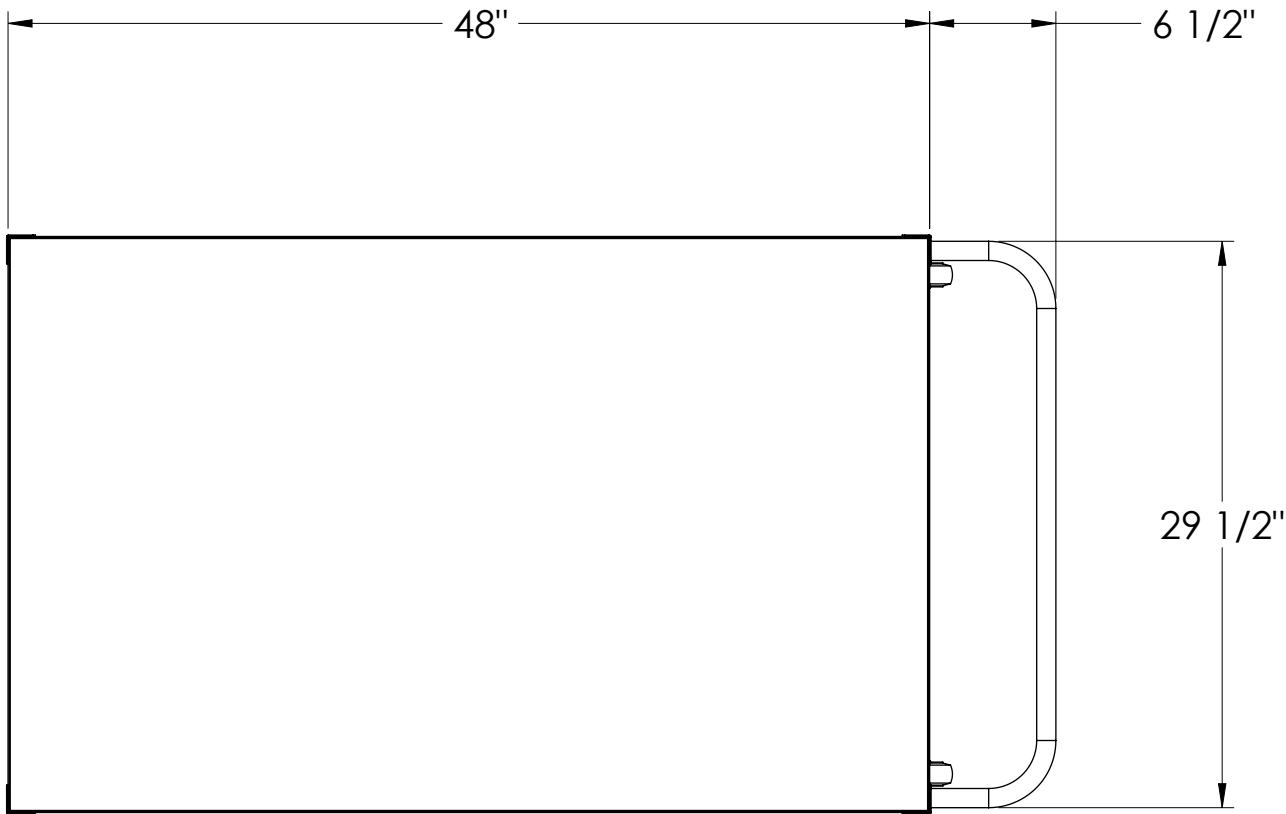

CUSTOMER <b>CUSTOMER NAME</b>		APPROVAL		TOLERANCE BLOCK: DIMENSIONS ARE IN INCHES		PROPRIETARY THIS DOCUMENT AND THE DATE DISCLOSED HEREIN AND HERewith IS NOT TO BE REPRODUCED, USED, OR OTHERWISE DISCLOSED IN WHOLE OR IN PART TO ANYONE WITHOUT WRITTEN AUTHORIZATION FROM MORTECH MFG.		MOPEC GROUP		Mopec		MORTECH ELEVATING PATHOLOGY MANUFACTURING	
PROJECT <b>PROJECT NAME</b>		SIGNATURE		DATE		DO NOT SCALE DRAWING		APPROVALS		DATE		TITLE	
						MATERIAL STAINLESS STEEL, 16 GA.		DRAWN BY D. FRADEJAS		01/21/25		MODEL - MXA348-S5	
						FINISH #4 POLISHED SHELVES		CHECKED BY				STAINLESS STEEL UTILITY CART- 48"L X 30"W	
								APPROVED BY				SIZE C	
												DWG NO. MXA348-S5-AP	
												REV X01	
												SCALE 1:8	
												NEXT ASSY.	
												SHEET 1	
												OF 1	