



115 V Autopsy Saw

REF 0810-000-000/
0810-MPC-000

INSTRUCTIONS FOR USE

R_x ONLY

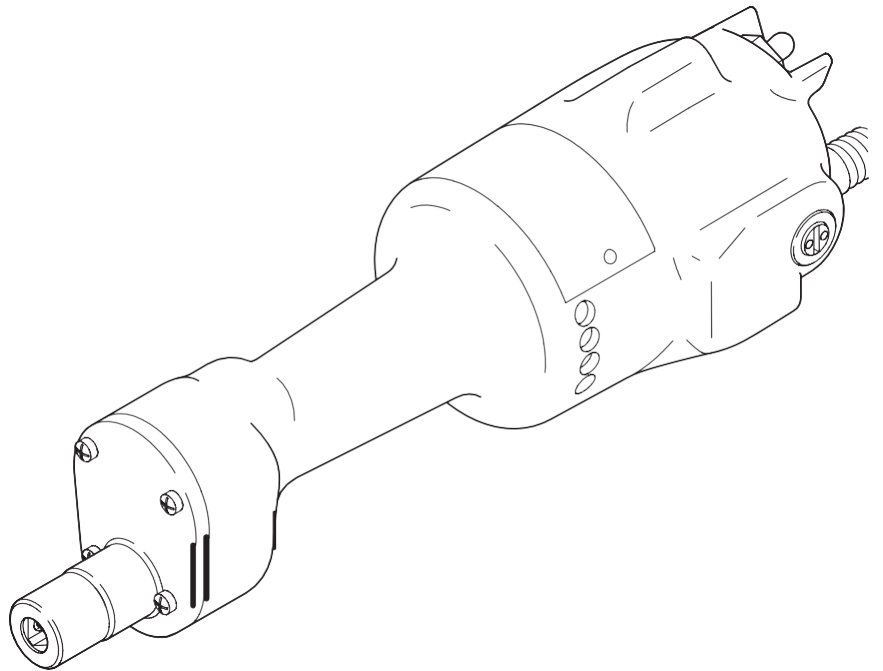

Introduction

This instructions for use manual contains information intended to ensure the safe, effective, and compliant use of your product. This manual is intended for pathologists, biomedical equipment technicians, and housekeeping staff. Keep and consult this reference manual during the life of the product.

The following conventions are used in this manual:

- A **WARNING** highlights a safety-related issue. ALWAYS comply with this information to prevent healthcare staff injury.
- A **CAUTION** highlights a product reliability issue. ALWAYS comply with this information to prevent product damage.
- A **NOTE** supplements and/or clarifies procedural information.

For additional information, including safety information, in-service training, or current literature, contact your Mopec sales representative.

Description

The 115V Autopsy Saw uses high-speed oscillating action to quickly cut through bone without harming soft tissue. Because exposure to infected tissue is reduced, the saw does not require a blade guard. The saw may be used for removing the skull cap, making linear cuts, or taking small bone specimens.



Safety Directives

WARNINGS:

- Before using this equipment, or any component compatible with this equipment, read and understand the instructions for use. Pay particular attention to safety information. Become familiar with the equipment before use.
- Only healthcare professionals trained and experienced in the use of this medical device should operate this equipment.
- Upon initial receipt and before each use, operate the equipment and inspect each component for damage. **DO NOT** use any equipment if damage is apparent.
- **DO NOT** modify any system component or accessory, including the power cord and power cord plug.
- **ALWAYS** position the equipment so that the power cord plug may be easily disconnected from the power supply.
- **DO NOT** use this equipment in areas in which flammable anesthetics or flammable agents are mixed with air, oxygen or nitrous oxide.
- **ALWAYS** follow the current local recommendations and/or regulations governing environmental protection and the risks associated with recycling or disposing of the equipment at the end of its useful life.

Definitions

The symbols located on the equipment and/or labeling are defined in this section or in the *Symbol Definition Chart*. See the *Symbol Definition Chart* supplied with the equipment.

SYMBOL	DEFINITION
	This symbol is intended to alert service personnel of the presence of voltage that may cause injury or fatal electric shock. Disconnect the device from the electrical supply before servicing.
	On
	Off

Accessories

 **WARNING:** Use only CMM-approved system components and accessories, unless otherwise specified.

NOTE: For a complete list of accessories, contact your Mopec sales representative.

Instructions

WARNINGS:

- ALWAYS disconnect the power cord plug from the facility power outlet before installing a blade. Failure to comply may cause fire, electric shock, or injury.
- Before operating the equipment, ALWAYS make sure the blade is securely installed and the blade retaining nut is tight. An improperly tightened nut may come loose and cause the blade to fracture.

NOTE: The wide portion of the adjustable section blade can be used for removing the skull cap or making long linear cuts. The narrow portion of the adjustable section blade can be used to remove a small bone specimen.

1. Insert the blade and arbor to its full depth in the triangular shaft hole.
2. Use the wrench attached to the power cord to tighten the set screw firmly against the arbor.

CAUTION: ALWAYS place the power cord where it will not be stepped on, tripped over, or otherwise subjected to damage or stress.

3. Connect the power cord plug to a facility power outlet.
4. Hold the instrument close to the saw blade with one hand, with the index finger extending under the oscillating head. In this position, the motor serves as a counterbalance.
5. Flip the toggle switch to turn on the saw.

 **WARNING:** DO NOT apply excessive pressure, such as bending or prying, with the blade. Excessive pressure may cause the blade to fracture.

NOTES:

- Cutting action is achieved by high speed oscillation of the blade. The blade cuts on both the backward and forward strokes of the excursion. To engage more blade teeth and allow for more efficient cutting, the blade should be moved slightly up and down as the cut progresses.
 - Soft tissue moves with the blade and is not cut by the blade; therefore, no blade guard is necessary to protect the operator.
6. Push the blade into the bone.
 7. Withdraw and advance the blade in the direction of the cut.
 8. Repeat this motion of alternating pressure along the direction of the cut until the cut is complete.
 9. Upon completion, flip the toggle switch to turn off the saw.

CAUTION: To reduce the risk of damage to the power cord, ALWAYS grasp the power cord plug, not the power cord, when disconnecting the saw.

10. Disconnect the power cord plug from the facility power outlet.

Cleaning

WARNINGS:

- ALWAYS disconnect the power cord plug from the facility power outlet before cleaning the equipment. Failure to comply may cause fire, electric shock, or injury.
 - Upon initial receipt and before each use, clean the equipment as indicated.
 - DO NOT sterilize the equipment.
 - DO NOT immerse or soak the equipment in liquid. DO NOT allow moisture or liquid to soak into electrical plugs, receptacles, or openings. Moisture or liquid inside the equipment may create an unsafe electrical condition, cause corrosion, and/or damage the electrical and/or mechanical components.
 - Before each use, make sure the equipment is completely dry. DO NOT use any equipment if moisture is present.
 - DO NOT use solvents, lubricants, or other chemicals, unless otherwise specified.
1. Disconnect the power cord plug from the facility power outlet.
 2. Wipe the external surfaces of the equipment with a soft, lint-free cloth moistened with a non-abrasive, mild detergent and water.
 3. Thoroughly dry the equipment with a soft, lint-free, absorbent cloth.

Inspection and Maintenance

WARNINGS:

- Only individuals trained and experienced in the maintenance of reusable medical devices should inspect, test, and maintain this equipment.
- ALWAYS disconnect the power cord plug from the facility power outlet before performing maintenance procedures on the equipment. Failure to comply may cause fire, electric shock, or injury.

NOTES:

- The Autopsy Saw has a lifetime lubrication system. No additional lubrication is required.
- For service, contact your Mopec sales representative.