

# MD100

---

## GROSSING WORKSTATION



## REFERENCE MANUAL



21750 Coolidge Highway • Oak Park, MI 48237 USA  
+1 800-362-8491 • 248-291-2040 • Email: [info@mopec.com](mailto:info@mopec.com)

Rev 6-17-14 ©

## **IMPORTANT INFORMATION**

**MODEL NO.:**

---

**SERIAL NO.:**

---

**DATE OF PURCHASE:**

---

**DATE OF INSTALLATION:**

---

**INSTALLATION NOTES:**

---

---

---

---

---

---

---

---

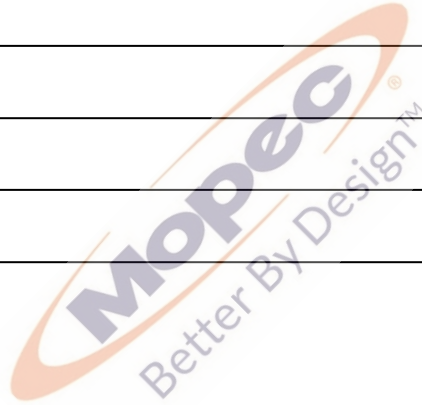

**SERVICE AND SUPPORT:**



21750 Coolidge Highway • Oak Park, MI 48237 USA  
+1 800-362-8491 • 248-291-2040 • Email: info@mopec.com

## **TABLE OF CONTENTS**

<b>INTRODUCTION</b>	<b>4</b>
<b>UNPACKING</b>	<b>5</b>
<b>INSTALLATION</b>	<b>6</b>
<b>CLEANING AND MAINTENANCE</b>	<b>7</b>
<b>WARRANTY</b>	<b>8</b>
<b>DIAGRAM</b>	<b>9</b>
<b>ISO 9001 CERTIFICATE</b>	<b>10</b>
<b>TUV CERTIFICATE</b>	<b>11</b>



## **INTRODUCTION**

The Mopec MD100 Grossing Workstation is an economical workstation ideal for small and large laboratories. Standard design features include the sloped work area, perimeter rinse, 2GFCI electrical outlets, hot and cold water faucet, pull out writing ledge, hand sprayer 14" x 15" x 10" deep sink. Below is a brief list of its features:

- The tabletop is fabricated of 14 Ga type stainless steel finished with a #4 satin finish, with integral sinks.
- Swing spout faucets are provided with vacuum breaker and wrist blade H/C handles, commercial quality cast brass chrome plated.
- Table Frame is fabricated of 1-5/8" Diameter welded legs with adjustable bullet feet for leveling. All joints shall be welded with a continuous type fill weld for structural strength. All welds shall be brushed clean removing any burrs and heat stains caused during the welding process. .
- All internal Plumbing lines are factory installed and require only trade hook-up.
- All components parts are U.L. listed

### **Available Options:**

- Heavy-Duty Continuous Duty Commercial Disposal 1 HP, 115/1/60. Complete with on/off switch, water solenoid and vacuum breaker plumbed and wired ready for use. U.L. Listed.
- Foot Pedals for the faucet for hands free operation.
- Hand Held Table Rinse / Spray which is fabricated of brass chrome plated along with high pressure nylon reinforced tubing.

## **UNPACKING**

The first step in receiving your new Grossing Workstation is to carefully inspect the exterior of the shipping container. Have the driver note any suspected damage on the bill of lading and sign it. If the crate and/or the product are damaged, immediately contact Mopec and the Carrier. Do not discard the shipping container; until your facility has received permission to do so from the Carrier (the damaged shipping material is important in settling freight claims).



## **INSTALLATION**

### **PROCEDURE**

Once the workstation is unpacked, carefully place it in the area where it is to be used. Align the edge of the table such that it's true and positioned according to the facility requirements. Level the table by placing a level on the table edges both side to side and end to end do not place the level on the table surface.

**“Important”**, the table surface is sloped toward the drain and will yield incorrect results.

Move the MD100 as close to its final position as possible. Remove the access panels. Connect the 115V, Single Phase, 60Hz, 20 Amp circuit, for the main power (located in the junction box), to your electrical service.

The cold water line is 3/4" and the hot water is 1/2" hard copper which will require a customer supplied on/off valves. We suggest ball type water valves to assure proper water flow in operating all table accessories. Drain lines are standard 1-1/2" IPS and need to be vented to assure proper drainage.

Electrical requirements are solely dependent on accessories. If the table excludes a disposal than one 115/1/60, 15 amps circuit is sufficient. If a disposal is purchased, another 115/1/60, 15 amp circuit will be added, this circuit is wired independently into the same junction box.

## **CLEANING AND MAINTENANCE**

### **DISINFECTING AND MAINTAINING STAINLESS STEEL SURFACES**

All stainless steel surfaces can be cleaned with soap and water, which will remove debris.

The stainless steel surfaces can be disinfected with a non caustic disinfectant. We suggest using BE045 Path Cloud or BE047 Bench Wipe for cleaning purposes. We recommend you **NOT USE** a bleach solution to clean your unit. Bleach will eventually erode stainless steel if not thoroughly rinsed. **The use of chlorine bleach will VOID THE STAINLESS STEEL WARRANTY**

During the cleaning we suggest wiping the surface in the same direction as the satin finish which will help lift up dirt from the grain finish.

Scratches can be removed simply by utilizing a "non-metallic" abrasive pad and rubbing in the same direction as the satin finish.

Since most abrasive pads vary from one supply to another, we suggest rubbing the entire surface to blend the scratch and blend the balance of the surface.

### **CORRECTING WASTE DISPOSAL JAMS**

The accidental entry of foreign material will cause any Waste Disposal unit to jam. To free jammed material, follow these steps **to avoid personal injury**.

1. Turn off Waste Disposal and shut off cold water.
2. Insert one end of your Self Service Wrench, provided with your Waste Disposal, into the center hole of the bottom of the disposer as shown (fig. 1).
3. Work the wrench back and forth until it moves freely for at least one complete revolution. **Remove the wrench before restarting the Disposal.**
4. Wait 3 to 5 minutes to allow Waste Disposal motor to cool and then push the reset button (fig. 1). **Be sure the main Disposal control switch is in the OFF position before pressing the reset button.**

**Fig. 1**

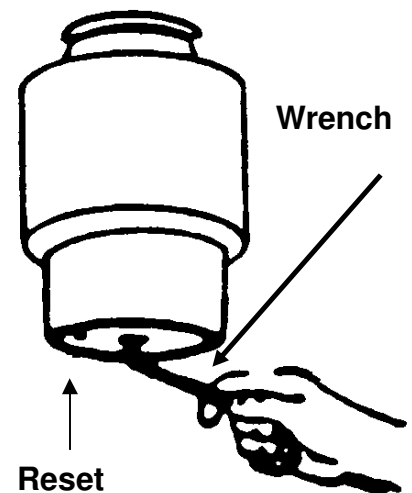

## **WARRANTY**

GROSSING WORKSTATION EQUIPMENT AND ALL PARTS THEREOF, MANUFACTURED BY MOPEC, IS WARRANTED TO OUR CUSTOMERS TO BE FREE FROM DEFECTS IN MATERIAL AND CONSTRUCTION WHEN SUBJECTED TO NORMAL USE AND SERVICE. THIS WARRANTY SHALL NOT APPLY TO ANY EQUIPMENT OR PART THEREOF, WHICH HAS BEEN SUBJECT TO ALTERATIONS, ACCIDENT, MISUSE, OR WHICH HAS BEEN USED MORE THAN ITS PUBLISHED CAPACITY.

OUR OBLIGATION UNDER THIS WARRANTY IS LIMITED TO REPAIRING OR REPLACING, WITHOUT CHARGE ANY PART OR PARTS OF SAID EQUIPMENT WHICH PROVE DEFECTIVE AND WHICH OUR EXAMINATION SHALL DISCLOSE TO OUR SATISFACTION TO BE THUS DEFECTIVE. WE DO NOT ACCEPT RESPONSIBILITY FOR CONSEQUENTIAL DAMAGE RESULTING FROM SUCH DEFECTIVE PARTS. THE PERIOD OF WARRANTY ON MOPEC EQUIPMENT IS AS FOLLOWS:

**STAINLESS STEEL MATERIAL:** STAINLESS STEEL IS WARRANTED FOR LIFE, TO BE FREE OF CORROSION. THIS WARRANTY IS APPLICABLE ONLY IF THE MATERIAL IS CLEANED AND DISINFECTED WITH A CLEANER THAT IS NOT CAUSTIC AND APPROVED FOR STAINLESS. SEE CLEANING AND DISINFECTING PROCEDURES.

**ALL EQUIPMENT:** EQUIPMENT IS WARRANTED IN ITS ENTIRETY FOR A PERIOD OF ONE (1) YEAR FROM THE DATE OF SALE. THIS WARRANTY INCLUDES PARTS AND LABOR FOR COVERED REPAIRS.

MOPEC WILL ACCEPT INCOMING DEFECTIVE PARTS, ONLY WHEN SHIPMENT IS PREPAID. THIS WARRANTY CONTRACT IS IN LIEU OF ALL OTHER WARRANTIES, AND RELEASES MOPEC OF ALL OTHER OBLIGATIONS OR LIABILITIES. IT NEITHER ASSUMES NOR AUTHORIZES ANY PERSON OR PERSONS TO ASSUME ANY OBLIGATION OTHER THAN THAT COVERED IN THIS WARRANTY.

MOPEC, 21750 COOLIDGE HIGHWAY OAK PARK, MI 48237



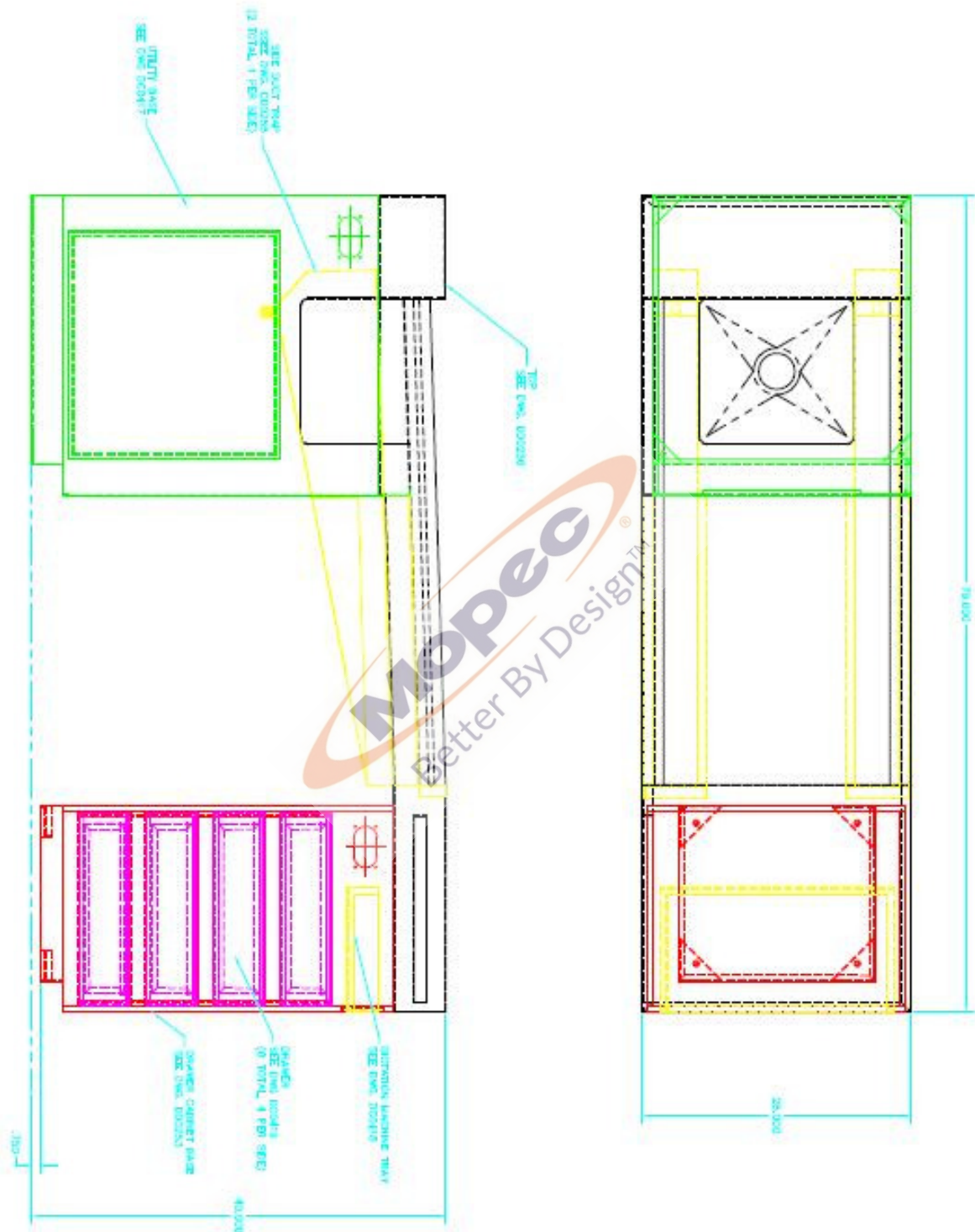



# CERTIFICATE OF REGISTRATION

This is to certify that

## **MP Acquisition, LLC DBA Mopec**

21750 Coolidge Highway, Oak Park, Michigan 48237 USA

operates a

## **Quality Management System**

which complies with the requirements of

## **ISO 9001:2008**

for the following scope of registration

**The registration covers the quality management system for the design, engineering, manufacturing and installation of equipment and distribution of supplies for morgue, pathology, histology and necropsy applications.**

Certificate No.: CERT-0078089  
File No.: 1068177  
Issue Date: March 11, 2014

Original Certification Date: April 9, 2008  
Current Certification Date: April 7, 2014  
Certificate Expiry Date: April 6, 2017

Chris Jouppi  
President,  
QMI-SAI Canada Limited

Samer Chaouk  
Head of Policy, Risk and Certification



ISO 9001



Registered by:  
SAI Global Certification Services Pty Ltd, 286 Sussex Street, Sydney NSW 2000 Australia with QMI-SAI Canada Limited, 20 Carlson Court, Suite 200,  
Toronto, Ontario M9W 7K6 Canada (SAI GLOBAL). This registration is subject to the SAI Global Terms and Conditions for Certification. While all due care  
and skill was exercised in carrying out this assessment, SAI Global accepts responsibility only for proven negligence. This certificate remains the property  
of SAI Global and must be returned to them upon request.  
To verify that this certificate is current, please refer to the SAI Global On-Line Certification Register: [www.qmi-saiglobal.com/qmi\\_companies/](http://www.qmi-saiglobal.com/qmi_companies/)

 **SAI GLOBAL**  
INFORM. INSPIRE. IMPROVE.

# Certificate



Certificate no.

CU 72041125 01

**License Holder:**

Mopec, Inc.  
21750 Coolidge Hwy  
Oak Park MI 48237  
USA

**Manufacturing Plant:**

Mopec, Inc.  
21750 Coolidge Hwy  
Oak Park MI 48237  
USA

Test report no.: USA-GB 30471065 001

Client Reference: Rick Bell

Tested to: UL 61010-1:2004  
CAN/CSA-C22.2 61010-1:2004  
NFPA 79:2002

Certified Product: Grossing Station

License Fee - Units

Model Designation: MMBXXXX  
(X= 0-9, A-Z, = not safety-relevant)

7

Rated Voltage: AC 115V, 60Hz  
Rated Current: 20A  
Protection Class: I

Special Remarks: To be installed according to the licensee's  
installation instructions.

7

Appendix: 1

Licensed Test mark:



Signatures

Date of Issue  
(day/mo/yr)  
04/02/2005

*Stephan Schmitt*  
Stephan Schmitt  
President

*M. Raap*  
Dipl.-Ing. M. Raap  
QA Certification Officer

TUV Rheinland of North America, Inc., 12 Commerce Road, Newtown, CT 06470. Tel (203) 426-0888 Fax (203) 426-4009