

JD305

ELECTRIC CADAVER LIFT



REFERENCE MANUAL



21750 Coolidge Highway • Oak Park, MI 48237 USA
+1 800-362-8491 • 248-291-2040 • Email: info@mopec.com

IMPORTANT INFORMATION

MODEL NO.:

SERIAL NO.:

DATE OF PURCHASE:

DATE OF INSTALLATION:

INSTALLATION NOTES:



SERVICE AND SUPPORT:



21750 Coolidge Highway • Oak Park, MI 48237 USA
+1 800-362-8491 • 248-291-2040 • Email: info@mopec.com

TABLE OF CONTENTS

IMPORTANT INFORMATION	2
TABLE OF CONTENTS	3
INTRODUCTION	4
RECEIVING INSPECTION	4
START UP INSTRUCTIONS	5
SPECIFICATIONS	6
OPERATING THE LIFT	7
CHARGING THE BATTERY	8
MAINTENANCE	9
CLEANING	10
TROUBLE SHOOTING	11
WARRANTY	12
PARTS LIST	13
UNIT DRAWING	14
ISO CERTIFICATE	15



INTRODUCTION

The JD305 Electric Cadaver Lift is a free rolling rechargeable, electric-hydraulic lift utilized alone, with the JD400 Roller Pallet, JD500 Cadaver Tray Lift Bar or JD600 Lift Bar. Yields an almost effortless means of handling a cadaver.

RECEIVING INSPECTION

The first step in operating your electric cadaver lift is to carefully inspect the unit for any visible damage. If visible damage is observed, do not discard the crate it was shipped in, even if it's beyond use. Contact the carrier and Mopec immediately. We will assist you in filing a claim for product repair and/or replacement. Also, check to see if all the parts are packaged. Contact Mopec immediately if parts are missing:



START UP INSTRUCTIONS

******* IMPORTANT *******

Battery Charging: Before operating the JD305 Electric Cadaver Lift for the first time, ensure the unit has been fully charged. You must connect the battery before charging. Remove the hydraulic shipping plug and replace with the breather cap provided.

With the lift in the lowest position check the following:

1. Remove plastic cover by removing the four hex bolts, two on top and one on each side (See figure one). Then disconnect the gauge and switch at the plastic connector. (See Figure 2).

Figure 1



Figure 2



2. Check for signs of damage, especially to the back cabinet that houses the battery, hydraulics and the electrical.
3. Remove plastic pipe plug from oil reservoir and screw in provided breather cap.
4. Connect negative (black) wire to negative battery terminal and tighten.
5. Check all electrical connections for tightness. Run unit up and down and check for any hydraulic leaks. DO NOT use the lift if there appears to be any damage.
6. Replace the plastic cover

SPECIFICATIONS

Features:

- Built-in Charger 12 V.D.C.
- 12 volt D.C. Hydraulic system
- Low Maintenance
- Remote Pendant Switch with magnetic back
- Powder Coat Finish
- Floor Lock

Technical Specifications:

- Max Capacity: 1000 lbs
- 12 volt Battery
- Built in battery charging module
- Overall Width: 39" (smallest)
- Fork Length 40"
- Minimum Fork Height (Down Position): 0"

Lifting capacity

Load Capacity: The load (including the tray, or container) that can be lifted to a given height at a given load center. Attempting to lift more than the load capacity can result in damage to the equipment or personal injury

Load Center: The distance from the backrest or vertical face of the fork to the center of an evenly distributed load

Load Distribution: Your Cadaver lift may tip over, in any direction if a load is shifted to the front or side unexpectedly

OPERATING THE LIFT

To ensure proper use, the following instructions must be adhered to:

1. Load rating: The capacity of your unit is shown on the metal tag attached to the truck. It is based on the load center also shown on the tag.
2. Do not use your unit for loads exceeding the size of the platform or forks
3. Never move the unit unless the load is in the fully lowered position
4. The lift is intended for movement of loads and lifting loads to work position, not for movement of loads in a raised position
5. The floor lock (brake) is designed for minimizing movement of unit during loading and unloading from the lift. It is not to be used to control the truck speed when being moved. Ensure the floor lock is engaged before loading and unloading
6. Do not perform any repair work on the lift if there is a load on the forks or if the forks or platform are in the raised position.
7. All personnel must stand clear of the lift while lifting or lowering the forks or platform.
8. Do not stand, sit or climb on lift or use to lift personnel.
9. Do not put hands, feet or stand underneath the forks or platform when raised.
10. Do Not use on soft, uneven or unstable surfaces.
11. Custom alteration of units for specific functions not made at the factory void all warranties without exceptions. User made alterations may result in unsafe conditions during use of unit

Operation

DO NOT attempt to move or operate the lift when charging the battery.

1. Place power switch to "ON" position
2. To raise lift, push "UP" button on hand control pendant
3. To Lower lift, push "DOWN" button on hand control pendant
4. Whenever the control button is released the lift will stop
5. Authorized operators should read and understand all instructions, precautions and warnings. Improper use of the lift could result in personnel injury and/or damage to load and equipment:
 - Use lift on hard surfaces only.
 - Make sure load is evenly distributed, not loose or unstable, and as far back on forks as possible.

DO NOT PICK UP LOADS ON THE TIPS OF FORKS OR EDGE OF PLATFORM

- Adjust forks to the maximum practical width to fit the attachments ordered. Use two forks, not one to pick up loads
- Make sure travel, work area and overhead are clear of obstructions before lifting or moving loads
- Make sure floor lock is in firm contact with floor before lifting or lowering loads

- Turn unit "OFF" when not in use to prolong battery life.
- Stay away from inclines or sloping floors. To stop your loaded lift in an emergency, carefully guide the truck into a wall or other solid object. Watch for falling or shifting loads.
- Watch your hands and feet. Always be alert to the area around you and watch where you are walking. A foot or hand caught between the lift and a fixed object may be crushed or even cut off.
- Operate on smooth, dry floors. Do not operate on ramps or inclines. Do not run over objects on the floor.
- Keep your truck under control at ALL times. Move at a comfortable walking speed. Perform all truck movements smoothly and at a speed that will give you control and time to react in an emergency.
- While maneuvering the lift, keep both hands on the push bars, and make certain the wheels won't hit your legs or feet.

Floor Lock

To activate the floor lock, step down on the silver tab behind the back cabinet

To disengage the floor lock, step down on the silver rods

Lift Controls

The controls on the electric powered cadaver lift are a push button pendant with a magnetic back. One button is for up and the other button is for down. Simply place the pendant onto any part of the frame.

CHARGING THE BATTERY

1. Plug charging cord into a nominal 120V grounded circuit outlet. Charging will begin.
2. Battery is fully charged when the voltmeter indicates 12.0 -13.4 volts. If less than 12.0 volts, the battery is not fully charged
3. When battery is fully charged, unplug charging cord from the electrical outlet
DO NOT attempt to move or operate the lift when charging the battery.
4. The battery charger cord can be left plugged in for an indefinite period of time. The charger may be used anytime to extend the operating time of your battery. You do not have to wait until the battery is run down.
5. The voltmeter will indicate battery condition even when the charger cord is not plugged in.



MAINTENANCE

Daily Maintenance Checks

WARNING: Battery should be recharged on a regular basis. Repeated total discharge of battery can result in battery failure.

1. Battery
 - a. Check charge level
 - b. Check for corroded and loose terminals
 - c. Visually inspect for cracks or damage to battery casing
 - d. Check for loose battery tie downs
2. Charger
 - a. Inspect wire connections
 - b. Check power cord for nicks/damage to insulation casing
3. Hydraulic System
 - a. Inspect pump and cylinder for leaks
 - b. Check fluid level. Reservoir should be a minimum of half full with a good grade of hydraulic oil (Premco #32 recommended)

DO NOT USE HYDRAULIC BRAKE FLUID

 - c. Check hydraulic fittings and hoses
 - d. Check piston rod for nicks/damage
4. Frame Assembly
 - a. Check Floor Lock
 - b. Check safety screen & guards
 - c. Check chain/roller assembly connections
 - d. Check for any worn or damaged parts

Monthly Maintenance Checks

1. Battery
 - a. Clean battery compartment area
 - b. Clean Terminals
2. Hydraulic System
 - a. Clean and inspect hydraulic cylinder
 - b. Lubricate chain with a rust inhibitive "Chain Lube"
 - c. Check tension with lift at its lowest height. Chain should be tight enough that it does not come off roller assembly
3. Frame Assembly
 - a. Clean and lubricate all roller bearings and cam followers
 - b. Clean and inspect all welds
 - c. Check wheels for wear and damage
 - d. Inspect nameplate for legibility

CLEANING INSTRUCTIONS

All painted areas can be cleaned easily with BE047 Bench Spray and Wipe Decontaminating Cleaner.

Any stainless steel surfaces can be cleaned with soap and water to remove debris. The stainless steel surfaces can be disinfected with a non-caustic disinfectant.



TROUBLE SHOOTING

Warranty Repairs

If the unit does not work properly contact MOPEC at 800-362-8491 within one year of the purchase date.

WARNING: Charger (P/N 109150) is specifically designed for use with the battery (P/N 109102). Use of batteries other than factory specified may result in damage to charger and will void all warranties.

TROUBLESHOOTING		
Problem	Check	Service Required
Stacker does not operate. (Pump does not run)	Power switch is in "OFF" position. Battery charger indicator lights. Voltmeter indicates 12 volts Battery terminals and cables Hydraulic oil level	Place in "ON" position. Charge battery until yellow or green light is lit. Charge battery until yellow or green light is lit. Clean if corroded (white powder). Tighten terminal bolts. Fill oil reservoir to proper level.
Stacker does not lift to full height. (Pump runs)	Oil leaks	Tighten fittings. Replace hydraulic hose if required.
Stacker creeps down under load	Dirt in oil holding valve open Oil leaks	Raise stacker to full height then lower in stages, 6" to 12" at a time to its lowest point. Repeat this cycle several times until dirt is cleared and unit operates properly. Replace oil with clean hydraulic oil if contaminated. Tighten fittings. Replace hydraulic hose if required. Replace "O" rings.
Pump runs continuously	Malfunction solenoid	Replace pump-motor solenoid.
LIMITED WARRANTY		

WARRANTY

MOPEC JD305 ELECTRIC CADAVER LIFT AND ALL PARTS THEREOF, MANUFACTURED BY MOPEC ARE WARRANTED TO OUR CUSTOMERS TO BE FREE FROM DEFECTS IN MATERIAL AND CONSTRUCTION WHEN SUBJECTED TO NORMAL USE AND SERVICE. THIS WARRANTY SHALL NOT APPLY TO ANY EQUIPMENT OR PART THEREOF, WHICH HAS BEEN SUBJECT TO ALTERATIONS, ACCIDENT, MISUSE, OR WHICH HAS BEEN USED MORE THAN ITS PUBLISHED CAPACITY.

OUR OBLIGATION UNDER THIS WARRANTY IS LIMITED TO REPAIRING OR REPLACING, WITHOUT CHARGE ANY PART OR PARTS OF SAID EQUIPMENT WHICH PROVE DEFECTIVE AND WHICH OUR EXAMINATION SHALL DISCLOSE TO OUR SATISFACTION TO BE THUS DEFECTIVE. WE DO NOT ACCEPT RESPONSIBILITY FOR CONSEQUENTIAL DAMAGE RESULTING FROM SUCH DEFECTIVE PARTS. THE PERIOD OF WARRANTY ON MOPEC EQUIPMENT IS AS FOLLOWS:

ALL EQUIPMENT: EQUIPMENT IS WARRANTED IN ITS ENTIRETY FOR A PERIOD OF ONE (1) YEAR FROM THE DATE OF SALE. THIS WARRANTY INCLUDES PARTS AND LABOR FOR COVERED REPAIRS.

MOPEC WILL ACCEPT INCOMING DEFECTIVE PARTS, ONLY WHEN SHIPMENT IS PREPAID. THIS WARRANTY CONTRACT IS IN LIEU OF ALL OTHER WARRANTIES, AND RELEASES MOPEC OF ALL OTHER OBLIGATIONS OR LIABILITIES. IT NEITHER ASSUMES NOR AUTHORIZES ANY PERSON OR PERSONS TO ASSUME ANY OBLIGATION OTHER THAN THAT COVERED IN THIS WARRANTY.

MOPEC, 21750 Coolidge Highway Oak Park, MI 48237

PARTS LIST

POWER-LIFT STACKER PARTS LIST

ITEM	QTY	DESCRIPTION	56"/60" LIFT	64"/68" LIFT	76"/80" LIFT
1	1	HYDRAULIC CYLINDER	051166	051164	051163
2	1	POWER UNIT	109101	109101	109101
3	1	BATTERY	109102	109102	109102
4	1	VOLTMETER	109104	109104	109104
5	1	BATTERY CABLE (NEG.)	052782	052782	052782
6	1	BATTERY CABLE (POS.)	052770	052770	052770
7	1	SOLENOID	109117	109117	109117
8	1	BATTERY CHARGER (110 V)	109150	109150	109150
	1	BATTERY CHARGER (220 V)	109153	109153	109153
9	1	HYDRAULIC HOSE	125824	125824	125824
10	1	ASS'Y: REMOTE CONTROL	052726	052726	052726
11	1	SWITCH	109325	109325	109325
12	1	LIFT CHAIN ASSEMBLY	050771	050771	050772
13	1	ROLLER CARRIER ASS'Y	260143	260143	260143
14	1	FLOOR LOCK	150001	150001	150001
15	2	WHEEL	053769	053769	053769
16	2	CASTER	054265	054265	054265

HYDRAULIC CYLINDER PARTS LIST

18	1	CYLINDER	051074	051073	051072
19	1	PISTON	051197	051196	051195
20	1	CYLINDER CAP	051198	051198	051198
21	1	SEAL KIT	220170	220170	220170
*21A		"O" RING	-----	-----	-----
*21B		"O" RING	-----	-----	-----
*21C		"O" RING	-----	-----	-----
*21D		"O" RING	-----	-----	-----
*21E		PISTON GUIDER RING	-----	-----	-----

PARTS SHOWN WITH (*), COMPRISE "SEAL KIT" P/N 220170.

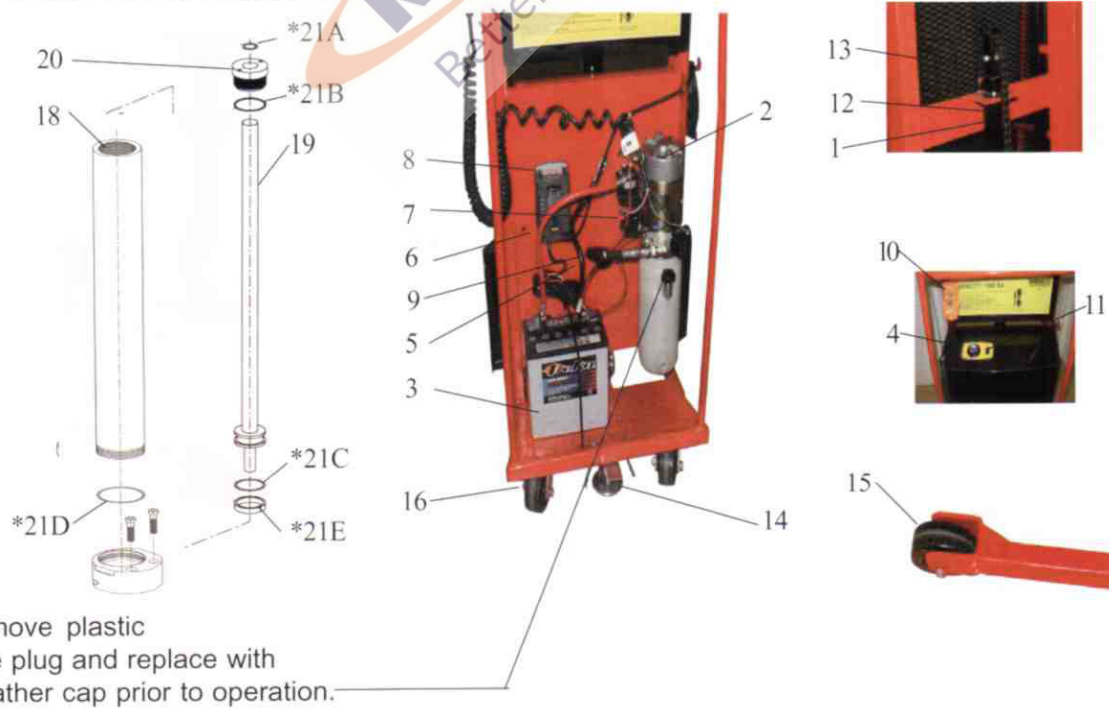

Technical drawing of a Mopec crane, showing top and side views with dimensions and a parts list.

Top View Dimensions:

- Overall width: 48 1/4"
- Distance from left edge to center of hook: 28 1/2"
- Distance from center of hook to right edge: 13 1/4"
- Distance from left edge to center of hook (alternative measurement): 13"
- Distance from center of hook to right edge (alternative measurement): 13"

Side View Dimensions:

- Overall height: 28"
- Distance from base to center of hook: 23"
- Distance from center of hook to top of mast: 34"
- Distance from base to center of hook (alternative measurement): 23"
- Distance from center of hook to top of mast (alternative measurement): 34"

Parts List:

1. CRANE - 200 lb.
2. CRANE - 100 lb.
3. CRANE - 50 lb.
4. CRANE - 25 lb.
5. CRANE - 12 1/2 lb.
6. CRANE - 6 1/4 lb.
7. CRANE - 3 1/4 lb.
8. CRANE - 1 3/4 lb.
9. CRANE - 7/8 lb.
10. CRANE - 3/4 lb.
11. CRANE - 1/2 lb.
12. CRANE - 1/4 lb.
13. CRANE - 1/8 lb.
14. CRANE - 1/16 lb.
15. CRANE - 1/32 lb.
16. CRANE - 1/64 lb.
17. CRANE - 1/128 lb.
18. CRANE - 1/256 lb.
19. CRANE - 1/512 lb.
20. CRANE - 1/1024 lb.
21. CRANE - 1/2048 lb.
22. CRANE - 1/4096 lb.
23. CRANE - 1/8192 lb.
24. CRANE - 1/16384 lb.
25. CRANE - 1/32768 lb.
26. CRANE - 1/65536 lb.
27. CRANE - 1/131072 lb.
28. CRANE - 1/262144 lb.
29. CRANE - 1/524288 lb.
30. CRANE - 1/1048576 lb.
31. CRANE - 1/2097152 lb.
32. CRANE - 1/4194304 lb.
33. CRANE - 1/8388608 lb.
34. CRANE - 1/16777216 lb.
35. CRANE - 1/33554432 lb.
36. CRANE - 1/67108864 lb.
37. CRANE - 1/134217728 lb.
38. CRANE - 1/268435456 lb.
39. CRANE - 1/536870912 lb.
40. CRANE - 1/1073741824 lb.
41. CRANE - 1/2147483648 lb.
42. CRANE - 1/4294967296 lb.
43. CRANE - 1/8589934592 lb.
44. CRANE - 1/17179869184 lb.
45. CRANE - 1/34359738368 lb.
46. CRANE - 1/68719476736 lb.
47. CRANE - 1/137438953472 lb.
48. CRANE - 1/274877906944 lb.
49. CRANE - 1/549755813888 lb.
50. CRANE - 1/1099511627776 lb.
51. CRANE - 1/2199023255552 lb.
52. CRANE - 1/4398046511104 lb.
53. CRANE - 1/8796093022208 lb.
54. CRANE - 1/17592186044416 lb.
55. CRANE - 1/35184372088832 lb.
56. CRANE - 1/70368744177664 lb.
57. CRANE - 1/140737488355328 lb.
58. CRANE - 1/281474976710656 lb.
59. CRANE - 1/562949953421312 lb.
60. CRANE - 1/1125899906842624 lb.
61. CRANE - 1/2251799813685248 lb.
62. CRANE - 1/4503599627370496 lb.
63. CRANE - 1/9007199254740992 lb.
64. CRANE - 1/18014398509481984 lb.
65. CRANE - 1/36028797018963968 lb.
66. CRANE - 1/72057594037927936 lb.
67. CRANE - 1/144115188075855872 lb.
68. CRANE - 1/288230376151711744 lb.
69. CRANE - 1/576460752303423488 lb.
70. CRANE - 1/1152921504606846976 lb.
71. CRANE - 1/2305843009213693952 lb.
72. CRANE - 1/4611686018427387904 lb.
73. CRANE - 1/9223372036854775808 lb.
74. CRANE - 1/18446744073709551616 lb.
75. CRANE - 1/36893488147419103232 lb.
76. CRANE - 1/73786976294838206464 lb.
77. CRANE - 1/147573952589676412928 lb.
78. CRANE - 1/295147905179352825856 lb.
79. CRANE - 1/590295810358705651712 lb.
80. CRANE - 1/1180591620717411303424 lb.
81. CRANE - 1/2361183241434822606848 lb.
82. CRANE - 1/4722366482869645213696 lb.
83. CRANE - 1/9444732965739290427392 lb.
84. CRANE - 1/18889465931478580854784 lb.
85. CRANE - 1/37778931862957161709568 lb.
86. CRANE - 1/75557863725914323419136 lb.
87. CRANE - 1/151115727451828646838272 lb.
88. CRANE - 1/302231454903657293676544 lb.
89. CRANE - 1/604462909807314587353088 lb.
90. CRANE - 1/1208925819614629174706176 lb.
91. CRANE - 1/2417851639229258349412352 lb.
92. CRANE - 1/4835703278458516698824704 lb.
93. CRANE - 1/9671406556917033397649408 lb.
94. CRANE - 1/19342813113834066795298816 lb.
95. CRANE - 1/38685626227668133590597632 lb.
96. CRANE - 1/77371252455336267181195264 lb.
97. CRANE - 1/154742504910672534362390528 lb.
98. CRANE - 1/309485009821345068724781056 lb.
99. CRANE - 1/618970019642690137449562112 lb.
100. CRANE - 1/1237940039285380274899124224 lb.
101. CRANE - 1/2475880078570760549798248448 lb.
102. CRANE - 1/4951760157141521099596496896 lb.
103. CRANE - 1/9903520314283042199192993792 lb.
104. CRANE - 1/19807040628566084398385987584 lb.
105. CRANE - 1/39614081257132168796771975168 lb.
106. CRANE - 1/79228162514264337593543950336 lb.
107. CRANE - 1/158456325028528675187087900672 lb.
108. CRANE - 1/316912650057057350374175801344 lb.
109. CRANE - 1/633825300114114700748351602688 lb.
110. CRANE - 1/1267650600228229401496703205376 lb.
111. CRANE - 1/2535301200456458802993406410752 lb.
112. CRANE - 1/5070602400912917605986812821504 lb.
113. CRANE - 1/10141204801825835211973625643008 lb.
114. CRANE - 1/20282409603651670423947251286016 lb.
115. CRANE - 1/40564819207303340847894502572032 lb.
116. CRANE - 1/81129638414606681695789005144064 lb.
117. CRANE - 1/162259276829213363391578010288128 lb.
118. CRANE - 1/324518553658426726783156020576256 lb.
119. CRANE - 1/649037107316853453566312041152512 lb.
120. CRANE



CERTIFICATE OF REGISTRATION

This is to certify that

MP Acquisition, LLC DBA Mopec

21750 Coolidge Highway, Oak Park, Michigan 48237 USA

operates a

Quality Management System

which complies with the requirements of

ISO 9001:2008

for the following scope of registration

The registration covers the quality management system for the design, engineering, manufacturing and installation of equipment and distribution of supplies for morgue, pathology, histology and necropsy applications.

Certificate No.: CERT-0078089
File No.: 1068177
Issue Date: March 11, 2014

Original Certification Date: April 9, 2008
Current Certification Date: April 7, 2014
Certificate Expiry Date: April 6, 2017

Chris Jouppi
President,
QMI-SAI Canada Limited

Samer Chaouk
Head of Policy, Risk and Certification



ISO 9001



Registered by:
SAI Global Certification Services Pty Ltd, 286 Sussex Street, Sydney NSW 2000 Australia with QMI-SAI Canada Limited, 20 Carlson Court, Suite 200,
Toronto, Ontario M9W 7K6 Canada (SAI GLOBAL). This registration is subject to the SAI Global Terms and Conditions for Certification. While all due care
and skill was exercised in carrying out this assessment, SAI Global accepts responsibility only for proven negligence. This certificate remains the property
of SAI Global and must be returned to them upon request.
To verify that this certificate is current, please refer to the SAI Global On-Line Certification Register: www.qmi-saiglobal.com/qmi_companies/

 **SAI GLOBAL**
INFORM. INSPIRE. IMPROVE.